

RoHS Compliance

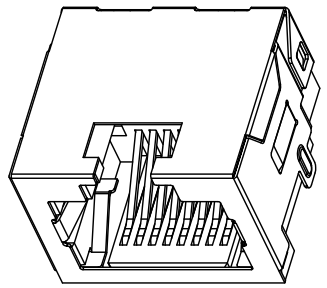
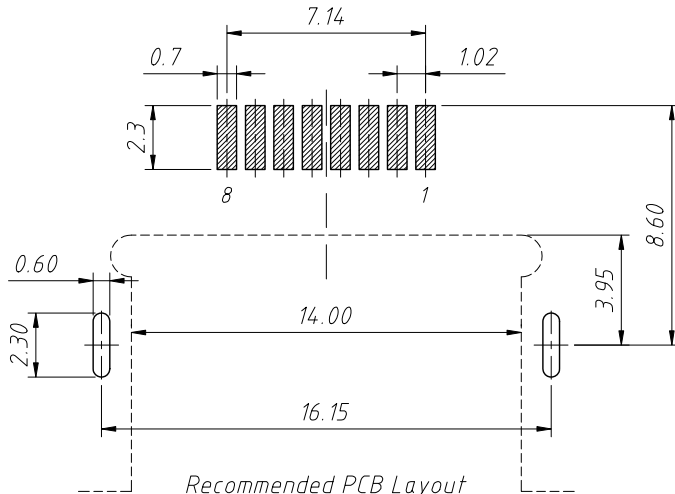
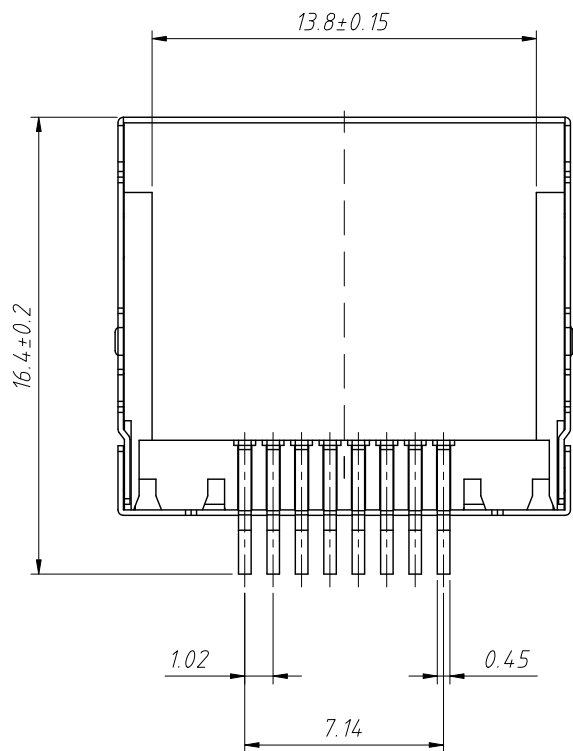
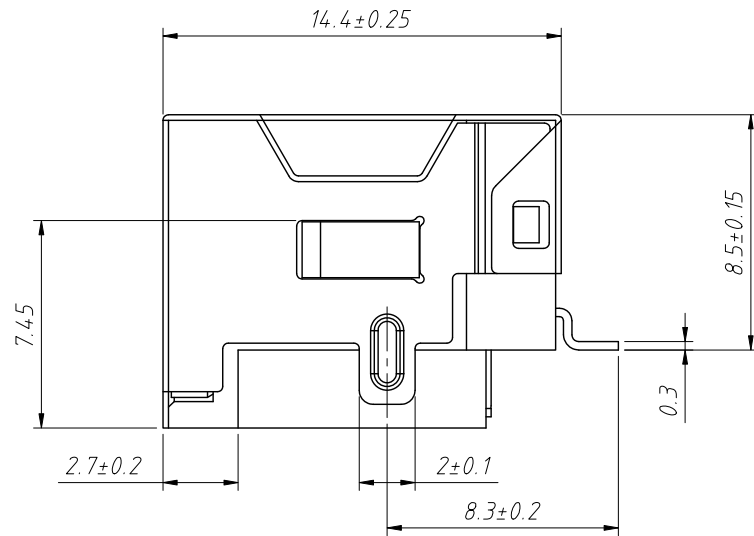
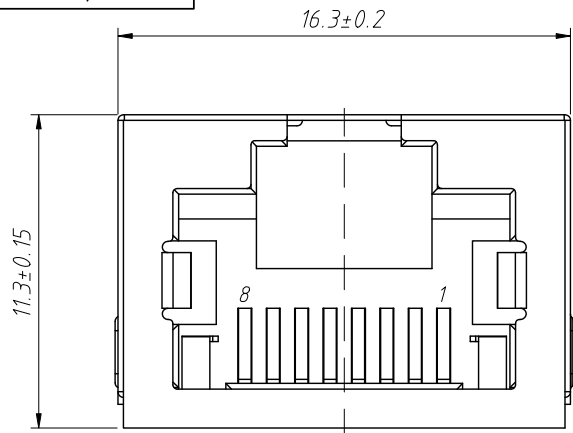

- Electrical:**
- 1.Voltage Rating:125VAC
 - 2.Current Rating:1.5A AMP
 - 3.Contact Resistance:20mΩ Max.
 - 4.Insulation Resistance:1000MΩ Min.@500VDC
 - 5.Dielectric Strength:1000 V AC Or 1500V DC RMS At 0.5mA 50Hz /60Hz For 1minute

- Materials:**
- 1.Housing:LCP,UL94V-0,Black
 - 2.Contact:Phosphor Bronze,T=0.3mm
Plating:Gold Plating At Contact Area . Matte Tin At Tail 100U Min,Nickel 30U Min . Over All.
 - 3.Shell:Brass,T=0.2mm
 - 4.Durability:750 Cycles Min.
 - 5.Mating/Unmating Force:30N/3.06KGf Max
 - 6.Retention Strength:50N Or 30N Min,For 60S±5S
- Environmental:**
1. Storage:-40°C~+85°C,Relative Humidity<80%
 - 2.Guarantee Period:12 Months
 3. Operation:-40°C~+80°C
 - 4.Ir Temperature:260± 5°C ,5~ 10 Seconds

Order Information:
L-KLS12-SMT19-8P8C-W-B-01-P

L: RoHS
 SMT series
 Point No:8P8C
 Shield Code:W-With Shield
 Insulator Colour:B=Black
 Plating:
 01:Fu" Gold 02:3u" Gold 03:6u" Gold
 04:15u" Gold 05:30u" Gold
 Packing:R-Reel P-Blister Tray

ANGLE TOLERANCE	PROJECTION	Description:	RJ45-8P8C SMD Jack Horizontal, Mid Mount H4.2mm Without LED
±3°			
GENERAL TOLERANCE	UNITS	mm	KLS P/N:
x.x ±0.30	SHEET SIZE	A4	L-KLS12-SMT19-8P8C-W-B-01-P
x.xx ±0.20	Draw:Jenny	Daniel	2022-06-15
x.xxx ±0.10	Check:Daniel	Daniel	2022-06-15

