

RECOMMENDED PCB LAYOUT

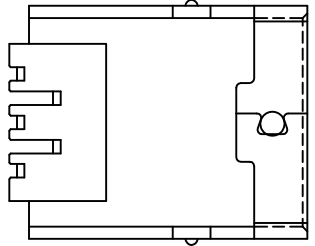

**Material**  
 Housing:Hing Temperature Thermoplastic,UL94V-0 LCP,Black.  
 Contact:Copper Alloy C2680.  
 Shell:Copper Alloy C2680/SPCC.

**Finish:**  
 Contact:Piated Gold In Mating Area;Tin On Solder Talls.  
 Shell:Nickel Plating.

**Electrical:**  
 Current Rating:1.0A/Contact Terminal.  
 Voltage Rating:30V DC  
 Contact Resistance:50mΩ Max.  
 Dielectric Withstanding Voltage:300 V AC AT Sea Level.  
 Insulation Resistance:100MΩ Min.  
 Connector Mate and Unmated Force  
 Mate Force:3.0kgf Max.  
 Unmated Force:0.7kgf Min.  
 Terminal Retenion:0.5kgf Min.

**Order Information**  
 L-KLS1- 229 - 5FQ-B

Color:B=Black  
 Serial number  
 Model  
 RoHS

GENERAL TOLERANCE	PROJECTION		Description:
X. ±0.30	UNITS	mm	CONN MINI USB RCPT, TYPE B R/A
.X ±0.25	SCALE	1:1	
.XX ±0.20	Draw by:	Jenny	KLS P/N: L-KLS1-229-5FQ-B
ANGLE TOLERANCE	Check by:		NingBo KLS ELECTRONIC CO.,L TD.
X. ±3°	Date	2018-03-01	
.X ±2°	SHEET	1 OF 1	
.XX ±1°			