

RECOMMENDED PCB LAYOUT

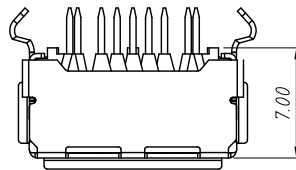
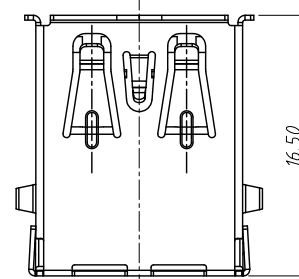
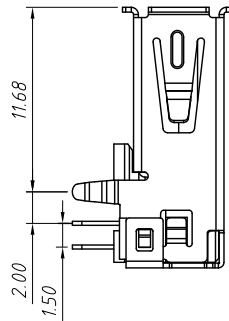
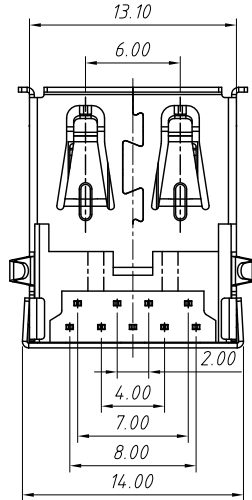
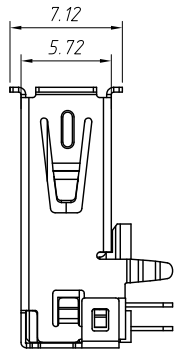

Material
 Housing: PBT+30%GF,UL 94 V-0
 Shell :Brass C2680 T=0.30mm ,Plated Nickel
 Terminal :Phosphor Bronze C5191 T=0.25mm
 ,Plated Gold/Tin

Electrical
 Voltage Current Rating:2AMP,30V AC
 Insulator Resistance: 100MΩ Min
 Contact Resistance: 50mΩ Max
 Withstanding Voltage: 300V AC

Mechanical
 Operating Temperature:-55°C TO +85°C.
 Mating Force: 35N MAX
 Unmating Force: 10N MIN.

Order Information

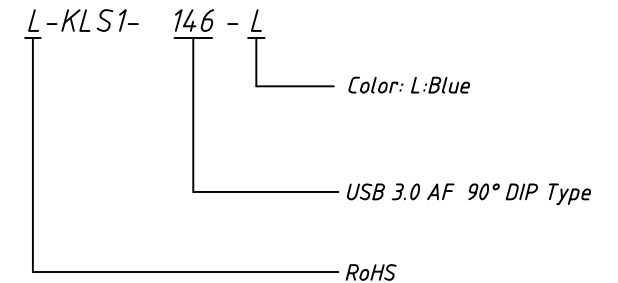

GENERAL TOLERANCE	ANGLE TOLERANCE	PROJECTION	Description:
.X ±0.60	.X ±5°	UNITS	USB 3.0 Type A Female CONN,R/A
.X ±0.38	.X ±3°	SHEET SIZE	
.XX ±0.25	.XX ±2°	KLS P/N:	

Draw by: Date	2018-03-01
Check by: Date	2018-03-01
SCALE	SHEET OF

KLS NingBo KLS ELECTRONIC CO.,LTD.