

PCB Terminal Blocks

KLS2-207R-5.00 5.00mm pitch PCB Terminal Blocks With Retainer

Electrical:

Rated current: 15A
Rated voltage: 300V
Wire range: 28-12AWG,0.2-2mm²

Material:

Housing: PA66, UL94V-0
Pin header: Brass, Tin plated

Mechanical:

Color: Grey
Poles: 2P~24P
Strip length: 8~9 mm
Temp. Range: -30°C~+120°C

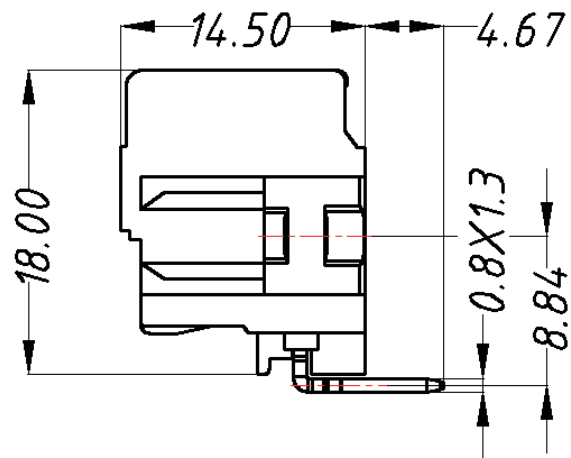
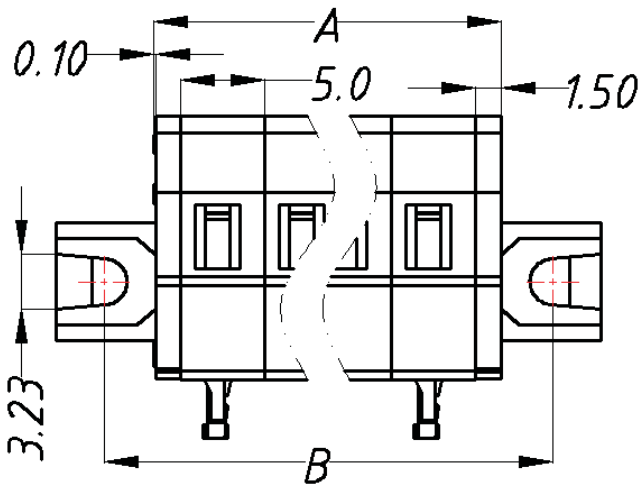
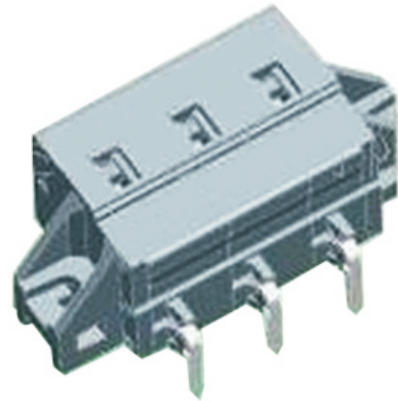

$$A = P \times 5.0 + 3.1$$

$$B = A + 6.12$$

ORDER INFORMATION

Product NO.: KLS2-207R-5.00-20P

