

## Trimmer Potentiometer

### KLS4-PT15 Series

#### FEATURES

- Carbon resistive element.
- Dust proof enclosure.
- Polyester substrate.
- Also upon request:
  - \*Wiper positioned at 50% or fully clockwise
  - \*Long life model for low cost control pot. Applications.
  - \*Low torque option
  - \*Supplied in magazines for automatic insertion.
  - \*Self extinguishable plastic UL 94V-0
  - \*Cut track option
  - \*Special Tapers
  - \*Mechanical detents



#### MECHANICAL SPECIFICATIONS

- Mechanical Rotation angle:  $265^{\circ} \pm 5^{\circ}$
- Electrical Rotation angle:  $250^{\circ} \pm 20^{\circ}$
- Torque: 0.5 to 2.5 Ncm. (0.7 to 3.4 in-oz)
- Stop torque: > 10 Ncm. (> 14 in-oz)
- Life: 10000cycles

#### ELECTRICAL SPECIFICATIONS

- Range of value:  $100\Omega \leq R_n \leq 5M\Omega$   
(Decad. 1.0-2.0-2.2-2.5-4.7-5.0)
- Tolerance:  $100\Omega \leq R_n \leq 1M\Omega \pm 20\%$  ;  
 $1M\Omega \leq R_n \leq 5M\Omega \pm 30\%$
- Max.voltage: 250 VDC(lin) 125VDC(no lin)
- Rated Power: 0.25W(lin) 0.12W( no lin)
- Taper: lin;log;alog
- Residual resistance:  $\leq 5\%$   $R_n(3\Omega \text{ min})$
- Equivalent noise resistance:  $\leq 3\%$   $R_n(3\Omega \text{ min})$
- Operating temperature:  $-25^{\circ}\text{C} \sim +70^{\circ}\text{C}$

## Rotors

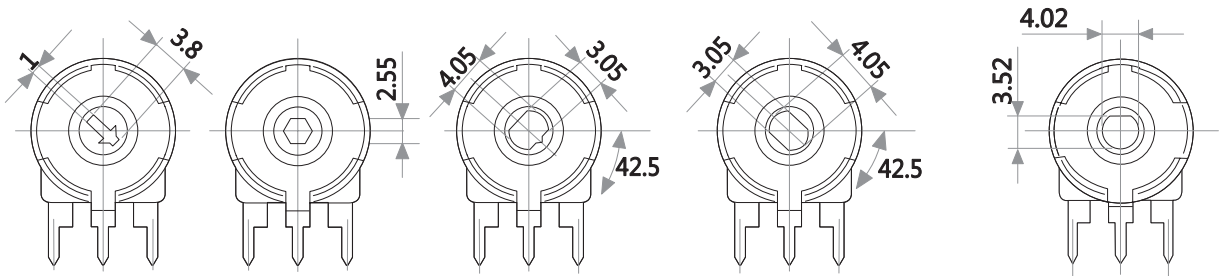

L - Screw driver thru hole

M - Hexagonal thru hole

N - Removable shaft or thumbwheel

G - Removable shaft or thumbwheel

R - Rotor R

## ORDER INFORMATION

Product No.: KLS4-PT15-M-V 221-A-2020

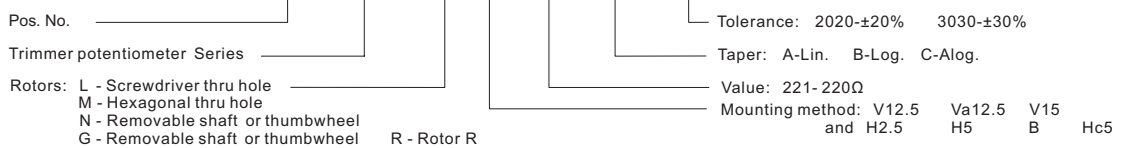

## Trimmer Potentiometer

KLS4-PT15 Series

### Mounting Methods



H = Vertical mount / Horizontal adjust

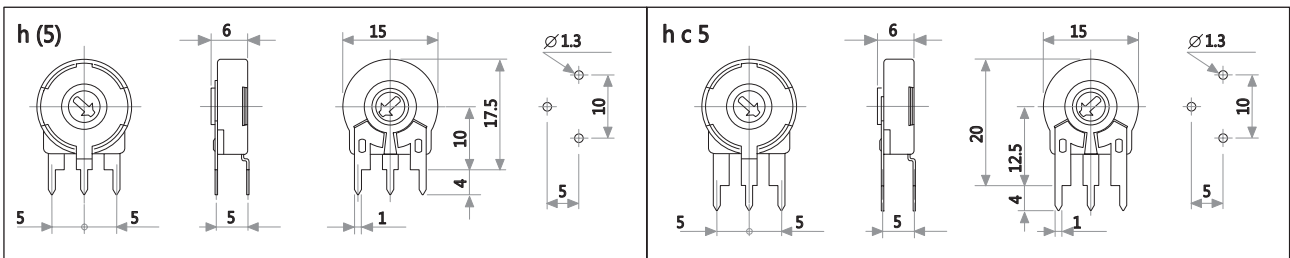
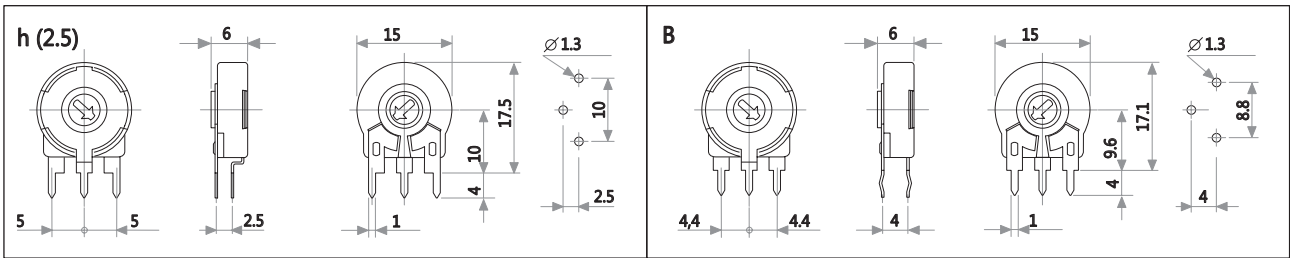

V = Horizontal mount / Vertical adjust

